

CHRISTOPHER HODGSON



**Whitstable**

**£189,950**

Leasehold

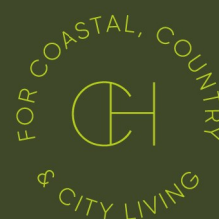

# Whitstable

## *First Floor Flat, 27a Oxford Street, Whitstable, Kent, CT5*

**1DB**  
A spacious apartment benefiting from its own private entrance and occupying the first floor of this attractive period building, ideally located on Whitstable's desirable Oxford Street.

The property is moments away from cafés, bars, boutique shops, highly regarded restaurants and is a short stroll to the beach, harbour and Whitstable station which is half a mile distant.

The accommodation has been subject of a recent programme of improvement and is arranged to provide a sitting room with South Easterly aspect, a kitchen, study, two double bedrooms and a bathroom.

The property is to be sold as an investment with a tenant in situ, and with the benefit of a new 125 year lease. No onward chain.



### LOCATION

Oxford Street is a highly sought after location enviably positioned in the heart of town providing convenient access to a diverse range of local shops, highly regarded restaurants, the seafront, bus routes and recreational amenities and a short walk away from the town's fashionable Harbour Street. Whitstable itself is a charming town by the sea with its working harbour and colourful streets of fisherman's cottages. The mainline railway station at Whitstable provides frequent services to London (Victoria) approximately 80 minutes and to the surrounding area. The high speed Javelin service provides access to London (St Pancras) with a journey time of approximately 73 minutes. The A299 is also easily accessible offering access to the A2/M2 leading to the channel ports and subsequent motorway network.

### ACCOMMODATION

The accommodation and approximate measurements (taken at maximum points) are:

#### FIRST FLOOR

- Sitting Room 12'0" x 10'10" (3.66m x 3.30m)
- Kitchen 9'7" x 7'10" (2.92m x 2.40m)
- Study 10'7" x 6'1" (3.23m x 1.85m)

- Bedroom 1 14'4" x 9'5" (4.37m x 2.87m)
- Bedroom 2 10'7" x 7'11" (3.23m x 2.41m)
- Bathroom 7'10" x 4'11" (2.39m x 1.50m)

### LEASE

A new 125 year lease will be granted on completion (subject to confirmation from the vendors solicitors).

### SERVICE/MAINTENANCE CHARGE

£500 per annum (subject to confirmation from vendor's solicitor).

### GROUND RENT

NIL (subject to confirmation from vendor's solicitor).

### TENANCY

The property is subject to an Assured Shorthold Tenancy which commenced 10/03/2026 with rent at the rate of £995 per calendar month.

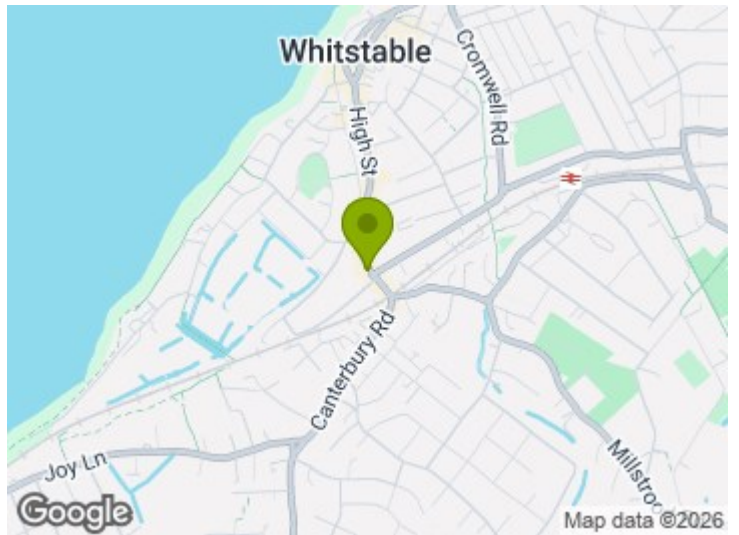

## First Floor

Approx. 55.0 sq. metres (591.7 sq. feet)

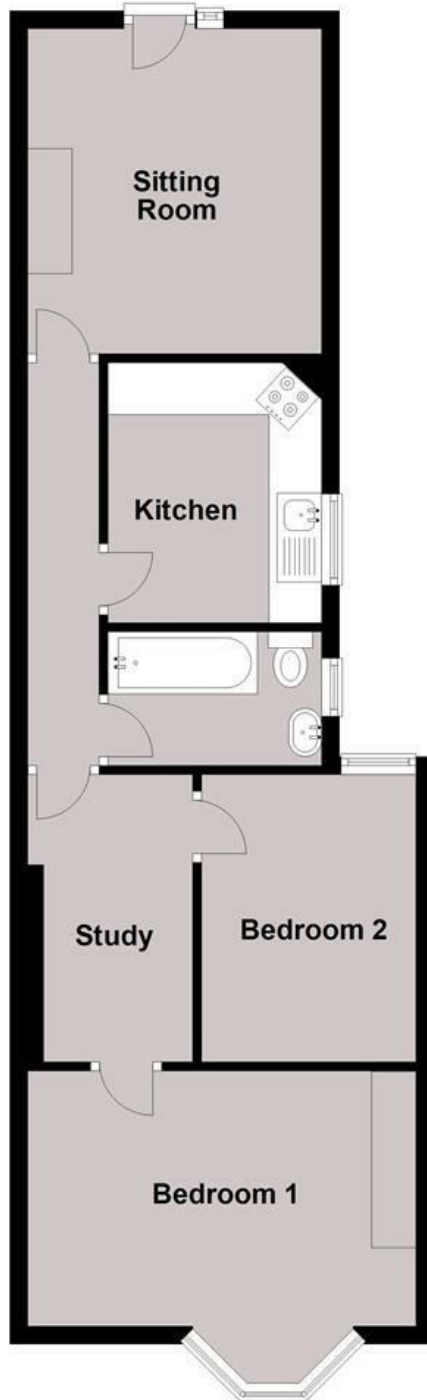

Total area: approx. 55.0 sq. metres (591.7 sq. feet)

**Council Tax Band A. The amount payable under tax band A for the year 2025/2026 is £1,535.50.**

Christopher Hodgson Estate Agents for itself and as for the vendor or lessor (as appropriate) gives notice that: 1 These particulars are only a general outline for the guidance of intending purchasers or lessees and do not constitute in whole or in part an offer or a Contract. 2 Reasonable endeavours have been made to ensure that the information given in these particulars is materially correct but any intending purchaser or lessee should satisfy themselves by inspection, searches, enquiries and survey as to the correctness of each statement. 3 All statements in these particulars are made without responsibility on the part of Christopher Hodgson Estate Agents or the vendor or lessor. 4 No statement in these particulars is to be relied upon as a statement or representation of fact. 5 Neither Christopher Hodgson Estate Agents nor anyone in its employment or acting on its behalf has authority to make any representation or warranty in relation to this property. 6 Nothing in these particulars shall be deemed to be a statement that the property is in good repair or condition or otherwise nor that any services or facilities are in good working order. 7 Photographs may show only certain parts and aspects of the property at the time when the photographs were taken and you should rely upon actual inspection. 8 No assumption should be made in respect of parts of the property not shown in photographs. 9 Any areas, measurements or distances are only approximate. 10 Any reference to alterations or use is not intended to be a statement that any necessary planning, building regulation, listed building or any other consent has been obtained. 11 Amounts quoted are exclusive of VAT if applicable. 12 Whilst reasonable endeavours have been made to ensure the accuracy of any floor plan contained in these particulars, all measurements and areas are approximate and no responsibility is taken for any error, omission or mis-statement. This plan is for illustrative purposes only and should be used as such by any prospective purchaser. 13 Any mapping contained within these particulars is for illustrative purposes only and should be used as such by any prospective purchaser. No responsibility is taken for any error, omission or mis-statement. 14 Any computer generated images contained within these particulars are for illustrative purposes only and should be used as such by any prospective purchaser.

Energy Efficiency Rating	
Current Rating	Potential Rating
A	B
71	74
England & Wales	

95-97 TANKERTON ROAD, WHITSTABLE CT5 2AJ | CHRISTOPHERHODGSON.CO.UK

